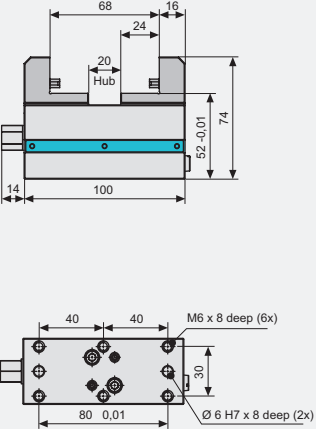
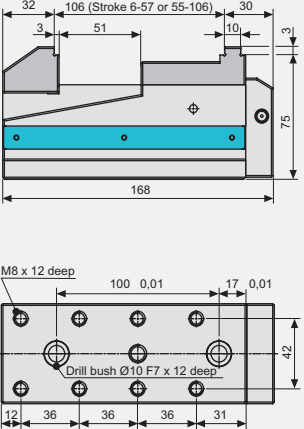
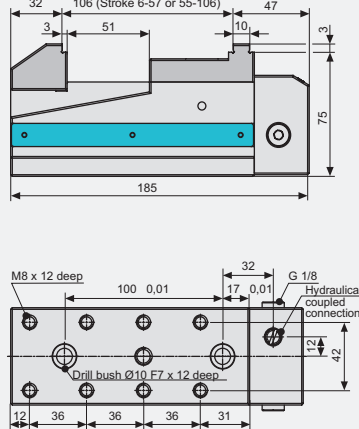

## Technical Data MC Clamping Systems

MC 40 Self-Centering mechanical	MC 60 Standard mechanical	MC 60 Standard hydraulic, power stroke 4 mm
		
<p>Jaw width 40 mm Clamping force 7.5 kN at 23 Nm Weight 1.6 kg without jaws</p>	<p>Jaw width 60 mm Clamping force 15 kN at 25 Nm Weight 3.3 kg without jaws <b>Part no. HR9.3583.0101</b></p>	<p>Jaw width 60 mm Clamping force 15 kN at 260 bar Weight 3.8 kg without jaws <b>Part no. HR9.3583.0201</b></p>
<p>on request</p>	<p>Step jaw, fixed, hardened <b>Part no. HR9.3583.6002</b></p>	<p>Step jaw, fixed, hardened <b>Part no. HR9.3583.6002</b></p>
	<p>Step jaw, movable, hardened <b>Part no. HR9.3583.6001</b></p>	<p>Step jaw, movable, hardened <b>Part no. HR9.3583.6001</b></p>
	<p>Basic jaw, fixed, soft, 60 x 65 x 25 mm <b>Part no. HR9.3583.6009</b></p>	<p>Basic jaw, fixed, soft, 60 x 65 x 25 mm <b>Part no. HR9.3583.6009</b></p>
	<p>Basic jaw, movable, soft, 60 x 35 x 25 mm <b>Part no. HR9.3583.6008</b></p>	<p>Basic jaw, movable, soft, 60 x 35 x 25 mm <b>Part no. HR9.3583.6008</b></p>
	<p>Torque wrench, 5-60 Nm <b>Part no. HR9.3583.7010</b></p>	<p>Socket wrench <b>Part no. HR1.2936.0001</b></p>
	<p>Socket nut SW 8 for 3/8" <b>Part no. HR1.3124.0104</b></p>	
	<p>Set = 4 clamping claws, with M10 screws <b>Part no. HR9.3583.7001</b></p>	<p>Set = 4 clamping claws, with M10 screws <b>Part no. HR9.3583.7001</b></p>
	<p>Set = 4 clamping claws, with M12 screws <b>Part no. HR9.3583.7002</b></p>	<p>Set = 4 clamping claws, with M12 screws <b>Part no. HR9.3583.7002</b></p>

## Standardised versions for zero point clamping and changing systems

### MC 60 for STARK 'Speedy 1000' system

MiniClamp: with:  
**HR9.3583.0101** (above) **HR9.3297.8011** adapter plate  
**HR9.3583.0201** (above) (factory-mounted)  
**HR9.3583.0301** (above) weight 1.4 kg

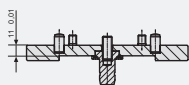

### MC 60 for STARK 'Speedy 2000' system

MiniClamp: with:  
**HR9.3583.0101** (above) **HR9.3297.8012** adapter plate  
**HR9.3583.0201** (above) (factory-mounted)  
**HR9.3583.0301** (above) weight 1.4 kg



**MC 60 Self-Centering  
mechanical**

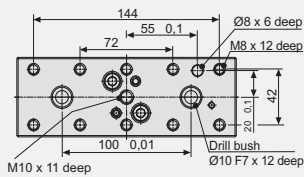
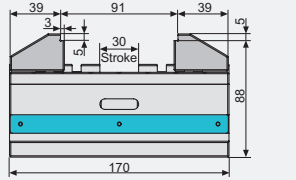

Jaw width 60 mm  
Clamping force 15 kN at 50 Nm  
Weight 3.8 kg  
without jaws  
**Part no. HR9.3583.0301**

Step jaw, movable,  
hardened  
**Part no. HR9.3583.6006**

Basic jaw, movable,  
soft, 60 x 42 x 25 mm  
**Part no. HR9.3583.6010**

Torque wrench,  
5-60 Nm  
**Part no. HR9.3583.7010**

Socket nut SW 12 for 3/8"  
**Part no. HR1.3124.0021**

Set = 4 clamping claws,  
with M10 screws  
**Part no. HR9.3583.7001**

Set = 4 clamping claws,  
with M12 screws  
**Part no. HR9.3583.7002**

**MC 100 Self Centering  
mechanical**

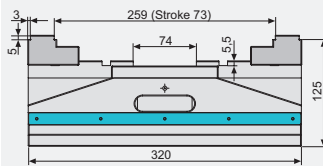

Jaw width 100 mm  
Clamping force 25 kN at 80 Nm  
Weight 17.8 kg  
without jaws  
**Part no. HR9.3585.0301**

Step jaw, movable,  
hardened  
**Part no. HR9.3585.6001**

Basic jaw, movable,  
soft, 100 x 60 x 28 mm  
**Part no. HR9.3585.6006**

Torque wrench,  
20-120 Nm  
**Part no. HR9.3792.6610**

Socket nut SW 14 for 1/2"  
**Part no. HR1.3124.0020**

Set = 4 clamping claws,  
with M12 screws  
**Part no. HR9.3585.7001**

**MC 125 Self-Centering  
mechanical standard design**

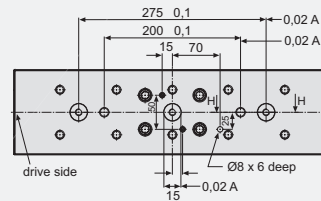
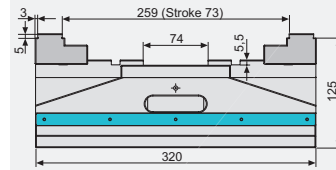

Jaw width 125 mm  
Clamping force 35 kN at 200 Nm  
Weight 49 kg  
without jaws  
**Part no. HR9.3586.0301**

Step jaw, movable,  
hardened  
**Part no. HR9.3586.6001**

Torque wrench,  
40-200 Nm  
**Part no. HR9.3792.6620**

Socket nut SW 19  
**Part no. HR1.3124.0019**

**MC 125 Zentric**  
special design, slide stepped  
**Part no. HR9.3586.8102**

**Special jaw**  
extra high (piece)  
**Part no. HR9.3586.6003**

step jaw, movable, and  
torque wrench, please  
see MC 125 Standard

